

09.08/25

PROJECT: B-6034

CONTRACT: DN01144

11/7/2025 10:53:39 AM
...\\Proj\Jackson65_rdy_tsh.dgn
User: jlanisford

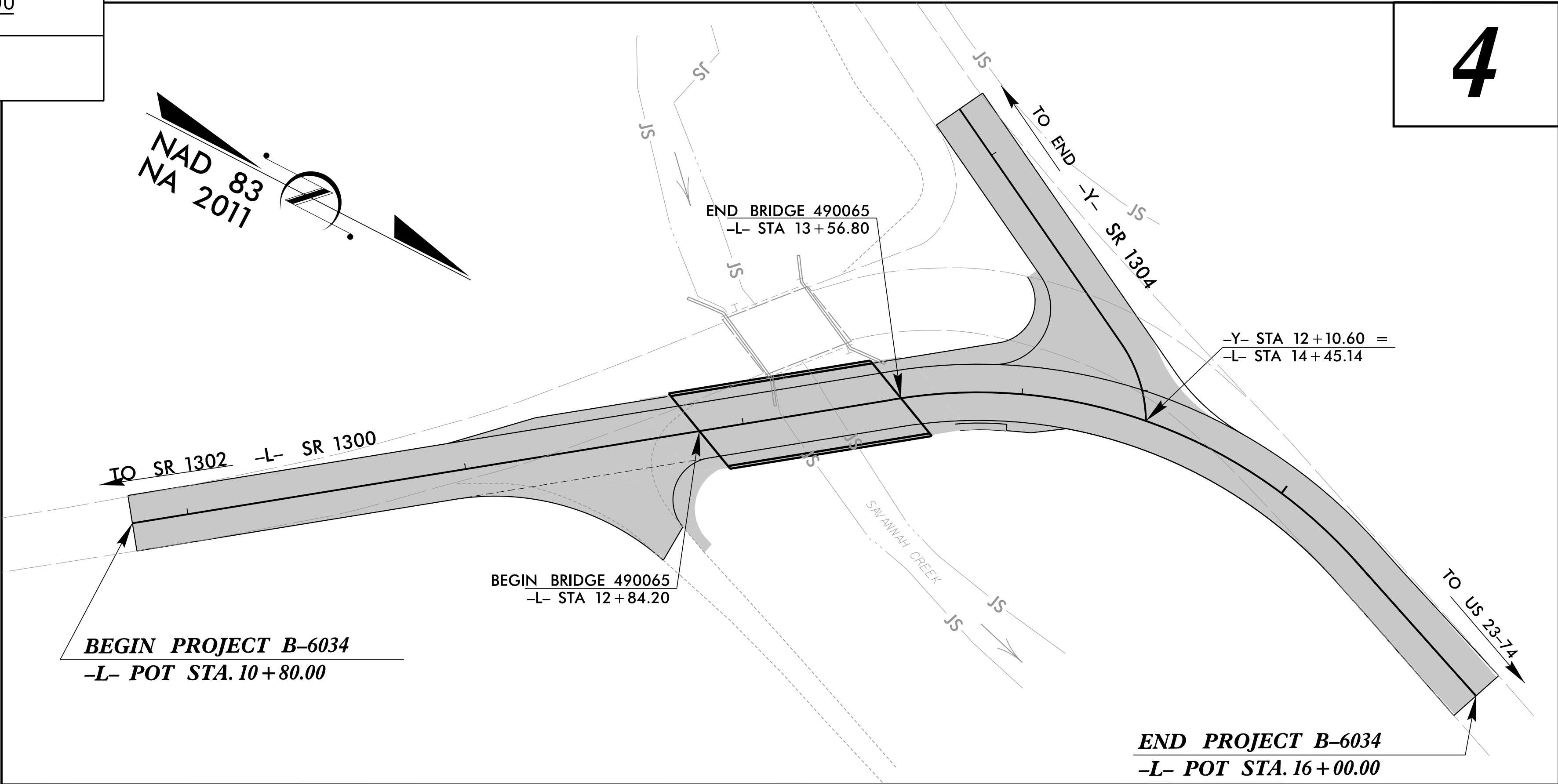
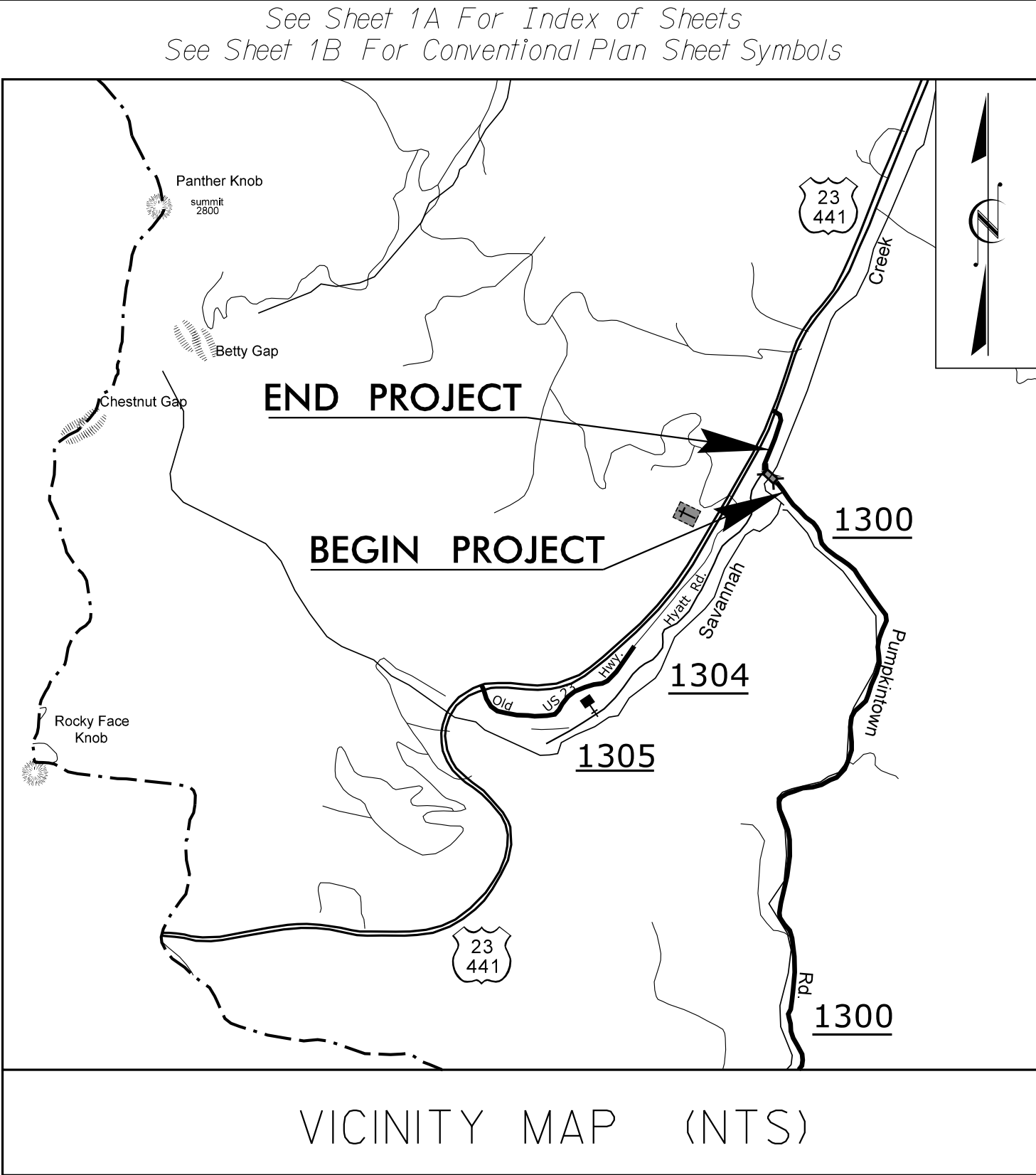

GRAPHIC SCALES

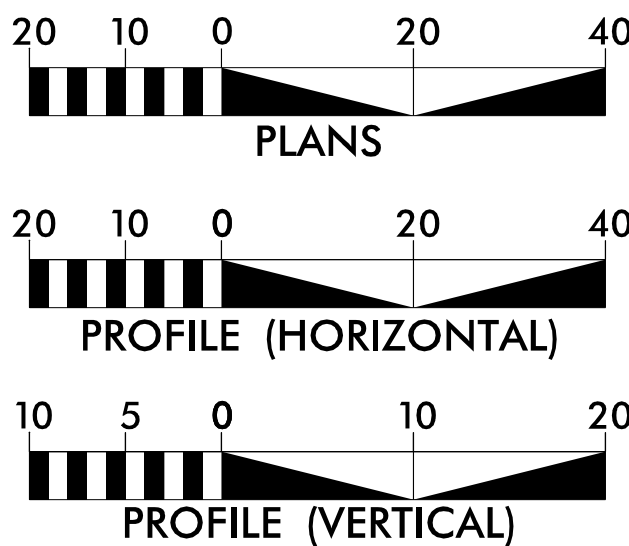

DESIGN DATA

ADT 2025 = 1060
ADT 2045 =
T = 6 % *
V = 35 MPH

FUNC CLASS =
RURAL LOCAL
SUBREGIONAL TIER

PROJECT LENGTH

LENGTH ROADWAY PROJECT B-6034 -L- = 0.085 MI
LENGTH STRUCTURE PROJECT B-6034 -L- = 0.014 MI
TOTAL LENGTH PROJECT B-6034 -L- = 0.099 MI



Prepared in the Office of:

Johnson, Mirmiran, & Thompson Inc.
4700 Falls of Neuse Rd, Suite 100,
Raleigh, NC, 27609
License No: C-3097

FOR THE NORTH CAROLINA DIVISION OF HIGHWAYS
2024 STANDARD SPECIFICATIONS

RIGHT OF WAY DATE:
AUGUST 5, 2024

LETTING DATE:
FEBRUARY 10, 2026

STEVEN RACKLEY, PE
PROJECT ENGINEER

JOHN LANSFORD, PE
PROJECT DESIGN ENGINEER

NC DOT CONTACT:
ZACHARY SHULER, PE
DIVISION 14 BRIDGE PROJECT MANAGER

HYDRAULICS ENGINEER



Designated by:
Bradley Kidner
SIGNATURE:

ROADWAY DESIGN
ENGINEER

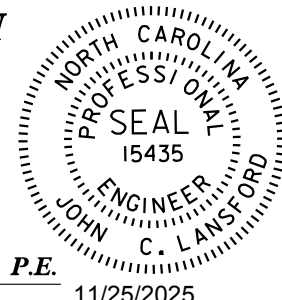

Signed by:
John Lansford
SIGNATURE:

